

Getting Started With BalliolCHAT

BalliolJCR IT

Mobile Client

It is easiest to download the element app.



Connecting to the `cs.ox.ac.uk` server can either be done directly by selecting the advanced options and then entering `matrix.cs.ox.ac.uk`. Or by visiting the website <https://chat.cs.ox.ac.uk>, and selecting configure client. You will then be directed to SSO login. After that join the Balliol JCR space.

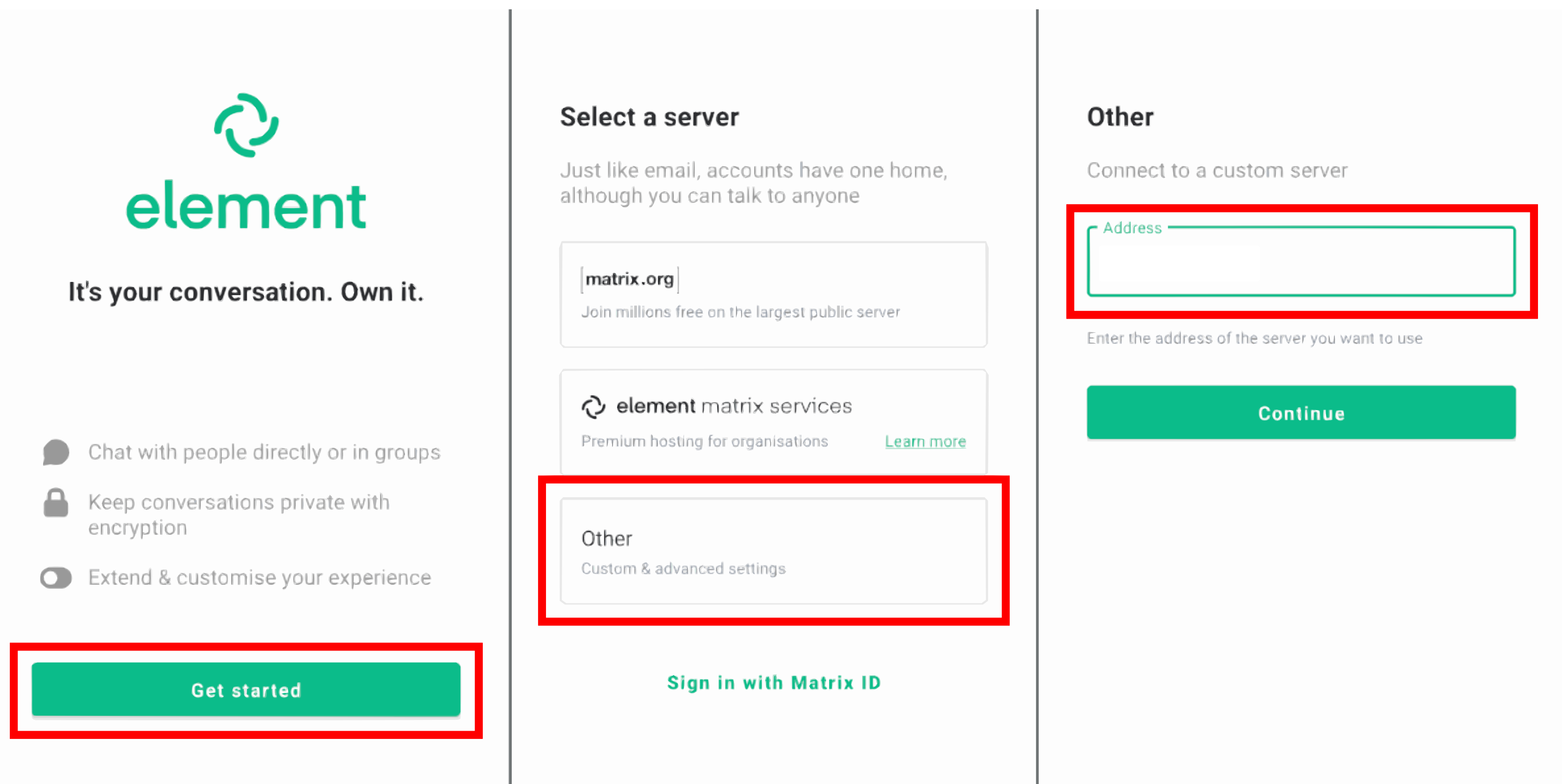
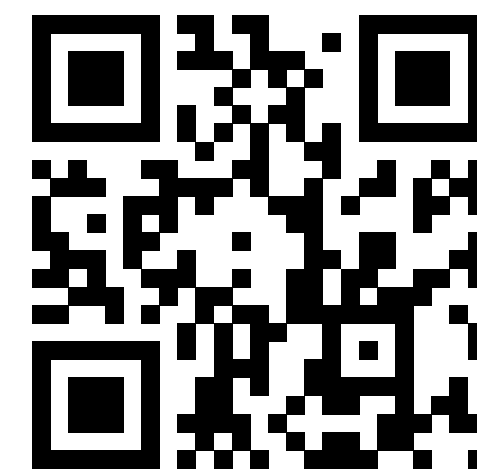

Why Matrix?

There are many services and programs for instant electronic communication. Matrix was chosen because it has the following characteristics:

- Open standard (no technical dead end)
- Communication protocol for federated real-time communication (no isolated solution but like e-mail with worldwide connectivity)
- Differentiated communication possible (1:1, multiple teams, topic-specific)
- Decentralized, persistent and interoperable communication (no central control instances, connectable with other protocols and tools)
- Data protection: end-to-end encryption standard in 1:1 conversations and (group) rooms, can be switched off in the latter
- Web application + desktop client + mobile apps available
- The contacts on your own cell phone are not automatically passed on to third parties (no address book upload)
- Connection to existing authentication systems (e.g. SSO Oxford login)
- Existing successful security audit
- Autonomy and control: locally installable (server location Oxford Computer Science Department)
- Recognize the presence status
- Active further development
- Up-and-coming use by other scientific institutions (e.g. lots of universities)

That was stolen mostly off <https://doc.matrix.tu-dresden.de/en/why/>

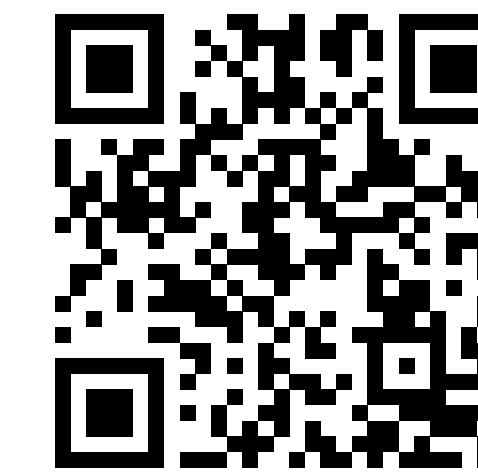

Visit the BalliolJCR website;

